

3 2 0

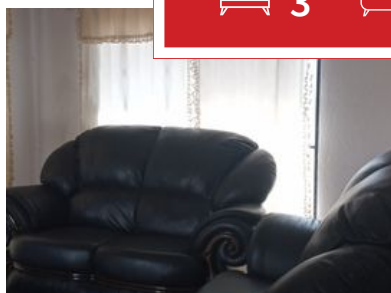

## Residential

This property is situated in Clayville Midrand it consist of three bedrooms, two bathrooms, lounge, kitchen and three cars carport and the house has space on the outside

### Monthly Bond Repayment

Calculated over 20 years at 10.75% with no deposit.

R8,934.01

### Bond Costs

These calculations are only a guide. Please ask your conveyancer for exact calculations

R21,450.00

### Transfer Costs

R28,244.00

### Monthly Rates

-

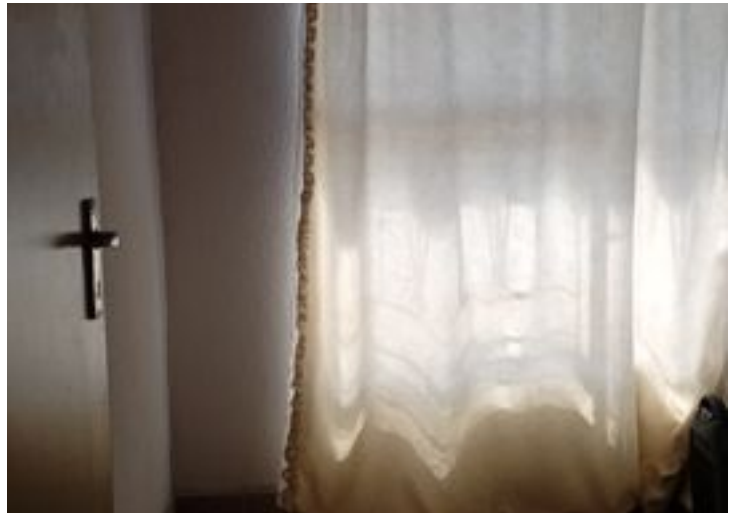
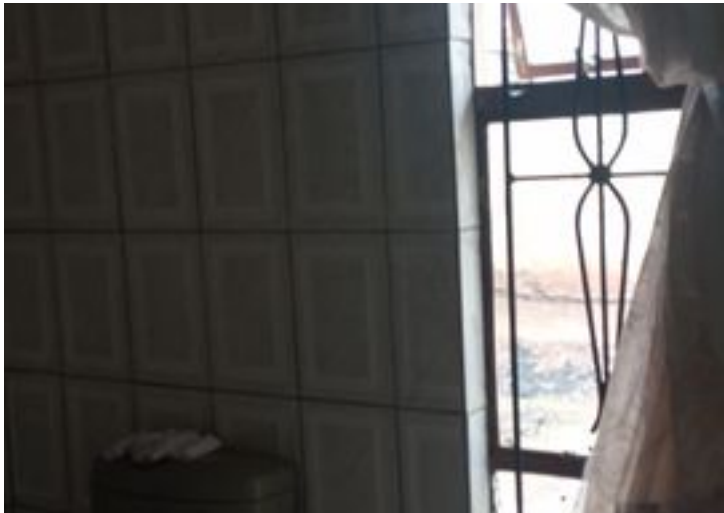

### INTERIOR

|              |     |
|--------------|-----|
| Bedrooms     | 3   |
| Bathrooms    | 2   |
| Kitchens     | 1   |
| Recep. Rooms | 1   |
| Furnished    | Yes |

### EXTERIOR

|                     |     |
|---------------------|-----|
| Carports / Parkings | 3   |
| Security            | Yes |
| Dom. Accom.         | 0   |
| Pool                | Yes |
| Views               | Yes |

### SIZES

|            |                   |
|------------|-------------------|
| Floor Size | 180m <sup>2</sup> |
| Land Size  | 280m <sup>2</sup> |



**Dumisani Mahlaba**  
Candidate Property Practitioner

**081 055 0809**  
dumisani@finehome.co.za